

RIVET NUT HYDRO-PNEUMATIC FLEX-5 TOOL

FLEX-5 TOOL



FLEX-5P: The Sherex FLEX-5P utilizes a Pull to Pressure method of installation. This method allows the same insert type to be installed into varying material thicknesses (within the Grip Range of the part) without any adjustment to the tool.



FLEX-5S: The Sherex FLEX-5S utilizes a Pull to Stroke method of installation. This method allows the insert to be installed to the same distance each time. This is helpful when installing into soft materials (prevents crushing of the base material) or when a specific Installed Length is required.

View our FLEX-5 Tool Demonstrations at www.sherex.com

FEATURES AND BENEFITS

Change over kit for converting between pull to pressure and pull to stroke

- Installs Rivet Nuts from: M3-M10 and 4-40-3/8-16.
- Push to start nose piece to spin on fastener.
- Single stage trigger.
- Automatic reverse with manual reverse bypass.
- Quick change mandrel design.
- Light weight (4.2 lbs).
- Can be suspended from a balancer.
- Socket head cap screw mandrel.
- Installs Rivet Nut Studs from M5-M8 and 10-24-5/16-24.
- Available in an in-line version.
- Split tool available (remote booster for lighter tool).
- Upgradeable to process monitoring.
- 5,000 lbs (22 kN) pulling force at 90 psi.
- 7 mm (0.276 in.) of available stroke.
- 2-3 second cycle time.
- All aluminum design for improved durability.

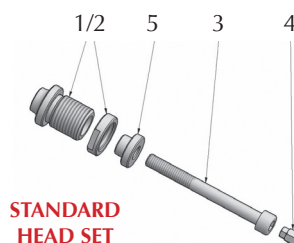

STANDARD HEADSET

HEAD SETS FOR STANDARD RIVET NUTS

Thread Size	Complete Headset	Anvil (1 + 2)	Mandrel (3)	Hex Driver (4)	Reducing sleeve (5)
M 3	FL5 - HS - M3	FL5 - HS - 00903	M -M3 -40	FL5 - HS -01003	FL5 - HS -09103
M 4	FL5 - HS - M4	FL5 - HS -00904	M -M4 -55	FL5 - HS -01004	FL5 - HS -09104
M 5	FL5 - HS - M5	FL5 - HS -00905	M -M5 -65	FL5 - HS -01005	FL5 - HS -09105
M 6	FL5 - HS - M6	FL5 - HS -00906	M -M6 -65	FL5 - HS -01006	FL5 - HS -09106
M 8	FL5 - HS - M8	FL5 - HS -00908	M -M8 -65	FL5 - HS -01008	FL5 - HS -09108
M 10	FL5 - HS - M10	FL5 - HS -00910	M -M10 -65	FL5 - HS -01010	n/a
4 - 40 UNC	FL5 - HS -0440	FL5 - HS -00854	M -0440 -175	FL5 - HS -00754	FL5 - HS -09154
6 -32 UNC	FL5 - HS -0632	FL5 - HS -00856	M -0632 -175	FL5 - HS -00756	FL5 - HS -09156
8 -32 UNC	FL5 - HS -0832	FL5 - HS -00858	M -0832 -175	FL5 - HS -00758	FL5 - HS -09158
10-24 UNC	FL5 - HS -1024	FL5 - HS -00850	M -1024 -250	FL5 - HS -00750	FL5 - HS -09150
10-32 UNF	FL5 - HS -1032	FL5 - HS -00850	M -1032 -250	FL5 - HS -00750	FL5 - HS -09150
1/4-20 UNC	FL5 - HS -2520	FL5 - HS -00848	M -2520 -250	FL5 - HS -00748	FL5 - HS -09148
1/4-28 UNF	FL5 - HS -2528	FL5 - HS -00848	M -2528 -250	FL5 - HS -00748	FL5 - HS -09148
5/16-18 UNC	FL5 - HS -3118	FL5 - HS -00840	M -3118 -250	FL5 - HS -00740	FL5 - HS -09140
5/16-24 UNF	FL5 - HS -3124	FL5 - HS -00840	M -3124 -250	FL5 - HS -00740	FL5 - HS -09140
3/8-16 UNC	FL5 - HS -3716	FL5 - HS -00842	M -3716 -250	FL5 - HS -00742	n/a
3/8-24 UNF	FL5 - HS -3724	FL5 - HS -00842	M -3724 -250	FL5 - HS -00742	n/a

RIVET NUT HYDRO-PNEUMATIC FLEX-5 TOOL & MS 100 TOOL

HEAD SETS FOR RIVET NUT STUDS

Thread Size	Complete Headset	Anvil (1 + 2)	Mandrel (3)	Hex Driver (4)	Reducing sleeve (5)
M5	FL5 - HS - M5S	FL5 - HS - S0905	FL5 - HS - 0S005	FL5 - HS - 01010	n/a
M6	FL5 - HS - M6S	FL5 - HS - S0906	FL5 - HS - 0S006	FL5 - HS - 01010	n/a
M8*	FL5 - HS - M8S	FL5 - HS - S0908	FL5 - HS - 0S008	FL5 - HS - 01010	n/a
10-24 UNC	FL5 - HS - 1024S	FL5 - HS - S0850	FL5 - HS - S1024	FL5 - HS - 01010	n/a
10-32 UNF	FL5 - HS - 1032S	FL5 - HS - S0850	FL5 - HS - S1032	FL5 - HS - 01010	n/a
1/4-20 UNC	FL5 - HS - 2520S	FL5 - HS - S0848	FL5 - HS - S2520	FL5 - HS - 01010	n/a
1/4-28 UNF	FL5 - HS - 2528S	FL5 - HS - S0848	FL5 - HS - S2528	FL5 - HS - 01010	n/a
5/16-18 UNC*	FL5 - HS - 3118S	FL5 - HS - S0840	FL5 - HS - S3118	FL5 - HS - 01010	n/a
5/16-24 UNF*	FL5 - HS - 3124S	FL5 - HS - S0840	FL5 - HS - S3124	FL5 - HS - 01010	n/a

*Head sets include p/n FL5-HS-12S92 adaptor nut

HEAD SETS FOR RIV-FLOAT®

Thread Size	Complete Headset	Anvil (1 + 2)	Mandrel (3)	Hex Driver (4)	Reducing sleeve (5)
M4	FL5-HS-2528R	FL5-HS-00848	M-2528-225	FL5-HS-00748	FL5-HS-09148
M5	FL5-HS-M5R	FL5-HS-R0995	M-M5-65	FL5-HS-01005	FL5-HS-09105
M6	FL5-HS-M6R	FL5-HS-R0996	M-M6-65	FL5-HS-01006	FL5-HS-09106
4-40 UNC	FL5-HS-2528R	FL5-HS-00848	M-2528-225	FL5-HS-00748	FL5-HS-09148
6-32 UNC	FL5-HS-2528R	FL5-HS-00848	M-2528-225	FL5-HS-00748	FL5-HS-09148
8-32 UNC	FL5-HS-2528R	FL5-HS-00848	M-2528-225	FL5-HS-00748	FL5-HS-09148
10-24 UNC	FL5-HS-1024R	FL5-HS-R0950	M-1024-250	FL5-HS-00750	FL5-HS-09150
10-32 UNF	FL5-HS-1032R	FL5-HS-R0950	M-1032-250	FL5-HS-00750	FL5-HS-09150
1/4-20 UNC	FL5-HS-2520R	FL5-HS-R0948	M-2520-250	FL5-HS-00748	FL5-HS-09148
1/4-28 UNF	FL5-HS-2528R1	FL5-HS-R0948	M-2528-250	FL5-HS-00748	FL5-HS-09148

HEAD SETS FOR RIV-FLOAT®-SHORT

Thread Size	Complete Headset	Anvil (1 + 2)	Mandrel (3)	Hex Driver (4)	Reducing sleeve (5)
M4	FL5-HS-M4SR	FL5-HS-SR0994	M-M4-55	FL5-HS-01004	FL5-HS-09104
M5	FL5-HS-M5SR	FL5-HS-SR0995	M-M5-65	FL5-HS-01005	FL5-HS-09105
8-32 UNC	FL5-HS-0832SR	FL5-HS-SR0858	M-0832-150	FL5-HS-00758	FL5-HS-09158
10-24 UNC	FL5-HS-1024SR	FL5-HS-SR0950	M-1024-225	FL5-HS-00750	FL5-HS-09150
10-32 UNF	FL5-HS-1032SR	FL5-HS-SR0950	M-1032-225	FL5-HS-00750	FL5-HS-09150

MS100 RIVET NUT TOOL

MS100		
Thread Size	Mandrel	Anvil
5/16-18	MA-373-3118	MA-369-3118
5/16-24	MA-377-3124	MA-369-3118
3/8-16	MA-374-3716	MA-370-3716
3/8-24	MA-378-3724	MA-370-3716
7/16-14	MA-375-4314	MA-371-4314
7/16-20	MA-301-4320	MA-371-4314
1/2-13	MA-376-5013	MA-372-5013
1/2-20	MA-379-5020	MA-372-5013
M8	MA-308-08MM	MA-318-08MM
M10	MA-310-10MM	MA-320-10MM
M12	MA-312-12MM	MA-322-12MM
M14	MA-314-14MM	MA-324-14MM

The MS 100 Rivet Nut installation tool installs rivet nuts from 5/16-18 to 1/2-20 and M8 to M14. It also installs 5/16 -18 and M8 Riv-Float®. The MS 100 tool comes with one mandrel and one anvil.

The MS 100 Rivet Nut installation tool should be operated at 80-100 psi. Sherex recommends the use of an air regulator, air filter and lubrication system to reduce the wear of internal components. It is also recommended to lubricate the mandrel to increase performance. Mandrels should be replaced when excessive thread wear occurs.

FLEX-5 TOOL

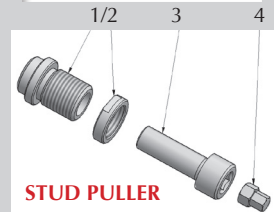

STUD PULLER

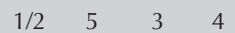

RIV-FLOAT® HEAD SETS

